

## Stearns County Property Viewer

<https://datafi.wsbeng.com/#!prod/county!mn!stearns!public>

This is the public online GIS application for viewing publicly available property information within Stearns County, MN.



### Tools inside the map window:

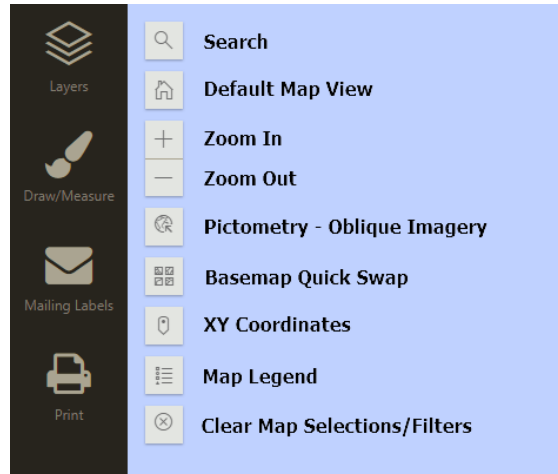

### Search:

Type in the Search text box to search by Parcel ID or by Property Address from the Parcel layer, or by address or location name using the Esri Local Geocoder. Alternatively, you can click the down arrow then choose which search you want to use to limit the search to just one of the three sets.

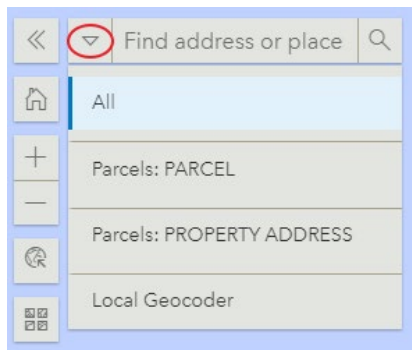

After you have typed a few characters, the dropdown will autofill with any valid matches. Select the match you want to zoom to that location. There will be a divider between each search type (Parcel ID, Property Address, or Local Geocoder).

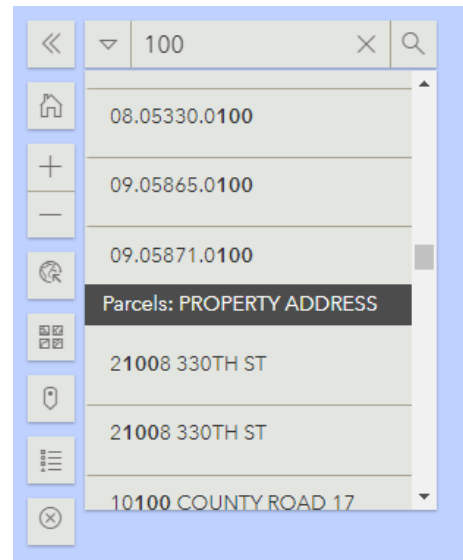

Once you zoom to the location, some information on the parcel will appear in the upper right, and additional information will be available in the tables at the bottom of the page. Click on the black boxes to activate the different tables. The green box will show the active table or tab.

You can also select a parcel by clicking on the parcel in the map window. This will also update the info window on the right and the tables at the bottom.

| Tax Year ↓ | Emv Land     | Emv Building |
|------------|--------------|--------------|
| 2024       | \$159,700.00 | \$0.00       |
| 2023       | \$145,200.00 | \$0.00       |
| 2022       | \$129,000.00 | \$0.00       |
| 2021       | \$63,000.00  | \$0.00       |

| Taxes                | Special Assessments  | Valuation       | Property Classification |
|----------------------|----------------------|-----------------|-------------------------|
| Property Information | Taxation & Valuation | Property Photos |                         |

## Layers Menu:

The layers menu allows you to toggle on or off different layers in the map. Some map layers are in groups, so you may need to click the arrow next to a group to see all the layers that are in that group.

The bottom of the layers list includes the aerial imagery flown specifically for Stearns County, as well as publicly available imagery from the state.

The green box with the white check must be on for both the group and the layer if you want to see the layer in the map.

Some layers are set to only draw at specific zoom levels, so if you don't see a layer that you have checked on, you should zoom in closer.

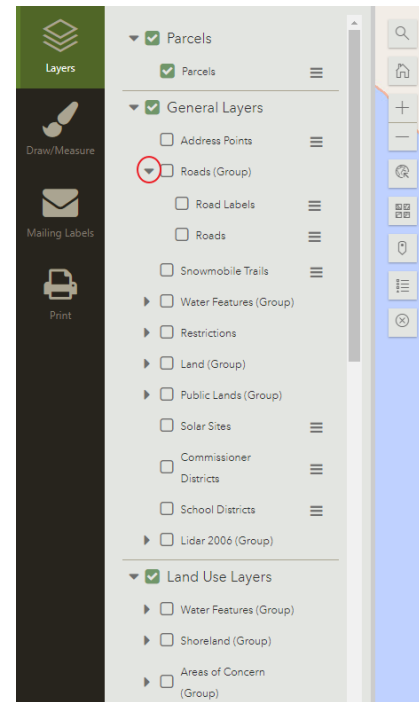

## Draw/Measure Menu:

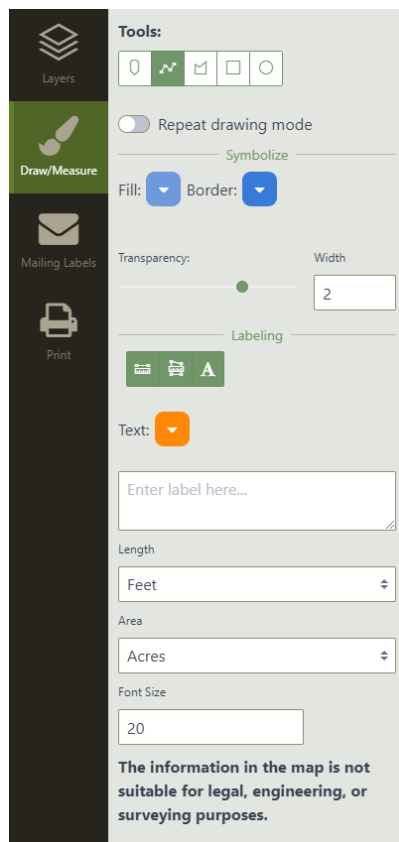

You can draw a Point, Line, Polygon, Rectangle, or Circle on the map with or without length and area measurement labels.

The five buttons across the top set if you are adding a Point, Polygon, Rectangle, or Circle. Click the button, then click and drag on the map to start drawing. The length and/or area measurements will show as you are drawing.

Once you complete your drawing the length and/or area will label if you have the labeling toggled on (green). The three labeling buttons are length, area, and additional text. The additional text label will show whatever text you type into the “Enter label here...” box under the length or area label.

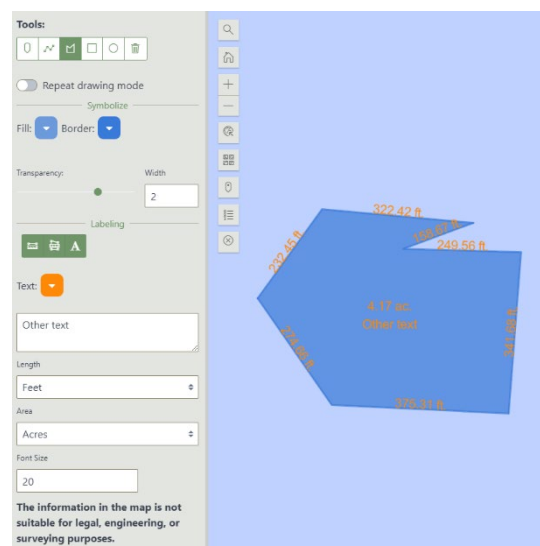

## Mailing Labels Menu:

You can select parcels to be included in a mailing labels list using the Point, Line, Polygon, Rectangle, or Circle tool, then click Show Results. There is a 1,000 parcel limit per selection/export.

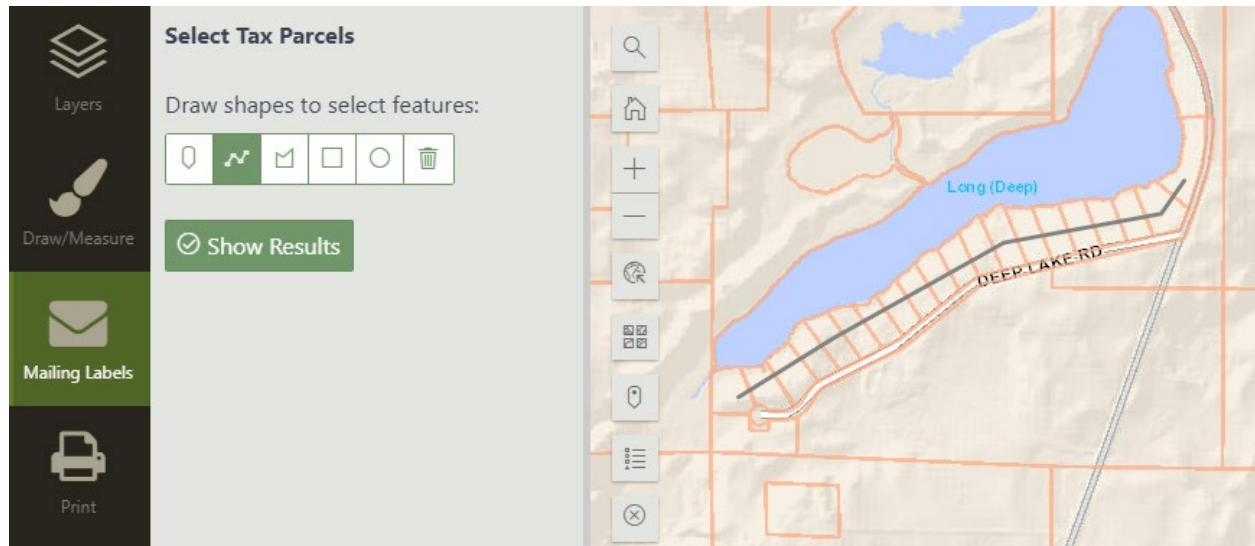

The selected parcels will highlight in blue. You can then buffer the selection if you want to add every parcel within the distance that you set, of the selected parcels to the list.

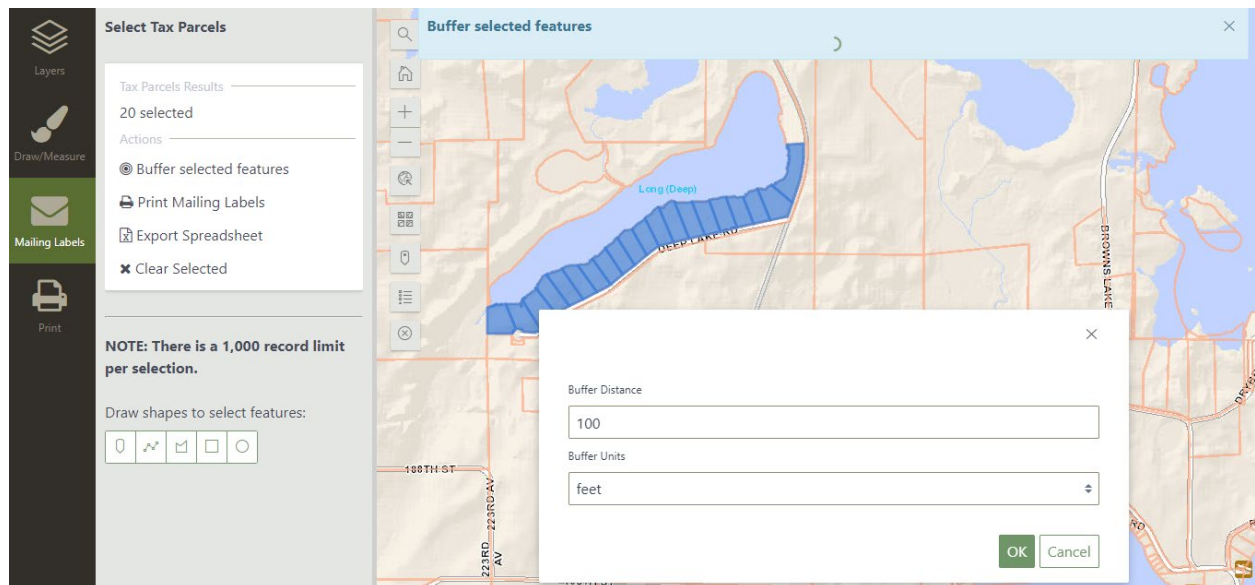

You can then select Print Mailing Labels or to export the mailing list as a spreadsheet. You will be asked if you want Owner, Resident or Both. Owner will give the property owner name and address. This address is tied to the parcel, but may not be in the same zip code, or even state. Resident will give the property address. Note that the property address may not be a valid mailing address, as the resident may get mail through a P.O. Box or may not receive mail at this location. The county does not track if the addresses are postal valid.

## Print Menu:

From the print menu, you can export a PDF, PNG, or JPEG map of an area of Stearns County showing all of the map features that you have turned on in the layers list.

You may type in a title for the map in the Title box, or leave it blank for no title.

Choose the page size and landscape or portrait.

Choose the file format you would like the export to be (PDF, PNG, or JPEG)

If you toggle on the “Enable preview/scale” you will see two red boxes on the map. The larger box is the page size, the smaller box is the area of the map that will be in the print.

If you would like the map to print at a specific scale, you can use the Common Scales dropdown. Otherwise use the slider to make the inside box cover the entire area you want to see on the print.

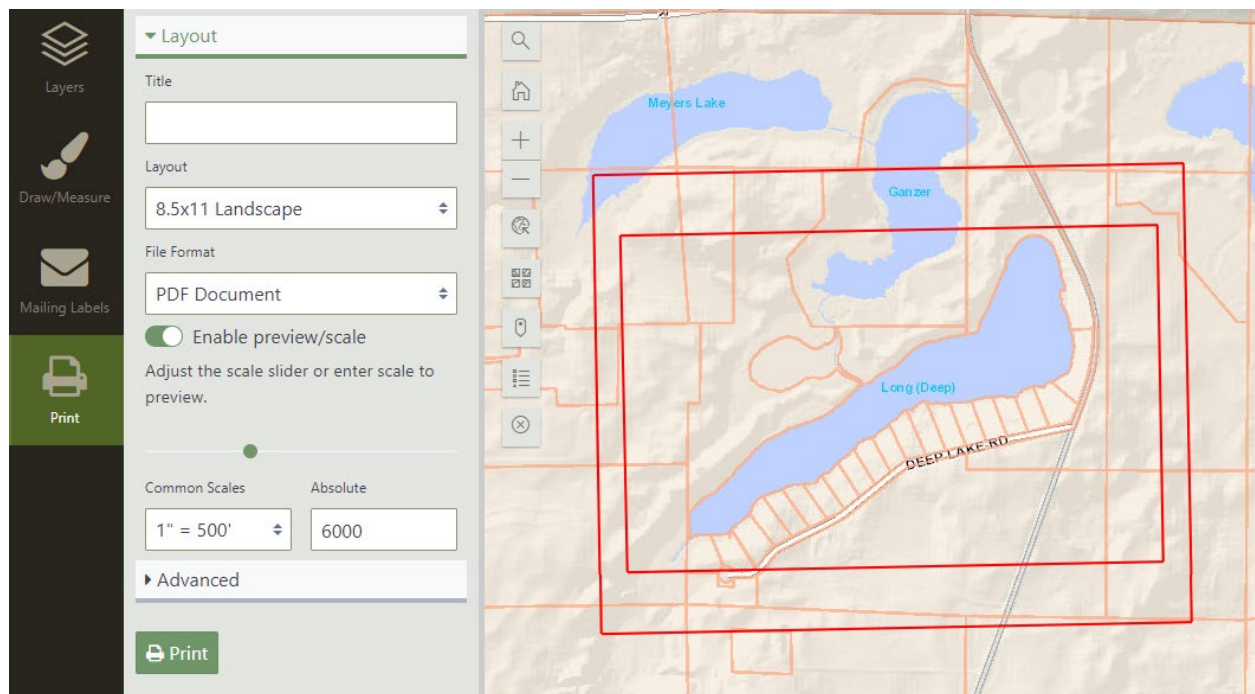

Click Print to export your map.